



普通型 / 调温型 / 数显型热风枪
Two Stage / Adjustable / Digital Heat Gun

97921A/97922A/97923A



使用说明书 \ User's Manual

中文

EN

在使用本产品前，请仔细阅读此说明书。
请妥善保存此说明书，以备日后查询使用。
Please read these instructions carefully before use.
Please keep these instructions for future reference.



警告

 打开设备时，带电元件及接头显露，可能导致生命危险，打开设备前应将电源插头从插座上拔下，调试前检查电源线和插头以及延伸线缆是否有电气和机械损伤。

 当心火灾和爆炸危险 热风机使用不当，尤其是在可燃材料和易爆气体附近使用的时候。切勿较长时间对着一个和相同的部位。热量可能会传导至不在视线范围内的可燃材料。

 **火灾和烧伤危险！** 不要触摸热的加热管元件和喷嘴。冷却设备。热空气射流切勿指向人或动物。
在更换风嘴之前或在使用后保管时，要将机具垂直靠在立面上，使其完全冷却。
如果热风工具在运行中自动关闭（热继电器），则关闭工具或断开工具电源与主电源的连接。再次使用前，首先冷却工具。

警示

 所设定的设备**额定电压**务必要与电源电压保持一致，EN 61000-3-11; $Z_{\max} = 0.215 \Omega + j 0.134 \Omega$ 。必要时咨询供电企业。
停电时，拔掉热风机的插头。

 在施工现场使用设备时，为确保人员安全，必须使用**漏电断路器**。

 设备运行时**必须进行监控**。
8岁以上的儿童以及在体质、感觉机能或心理能力上较差的或缺乏经验和认知的人员应在他人监管或接受与安全使用本机具相关的指导下且了解因不当使用而产生的危险之后，方可使用本机具。严禁儿童拿本机具当做玩具玩耍。不允许儿童在无人照看的情况下擅自进行清洁和用户保养。

 注意设备**防潮防湿**。

 **维修只能由授权的维修点进行。** 仅限于使用世达的原厂附件及配件。

产品中有害物质的名称及含量

部件名称	有害物质					
	铅 (Pb)	汞 (Hg)	镉 (Cd)	六价铬 (Cr (VI))	多溴联苯 (PBB)	多溴二苯醚 (PBDE)
塑料外壳	○	○	○	○	○	○
金属外壳/螺丝/轴承/夹钳	○	○	○	×	○	○
电机组件	○	○	○	○	○	○
控制组件(开关、PCB、热电偶等)	×	○	○	×	○	○
电源线/连接线	×	○	○	○	○	○
加热芯	×	○	×	×	○	○

本表格依据SJ/T 11364的规定编制。

○:表示该有害物质在该部件所有均质材料中的含量均在GB/T 26572规定的限量要求以下。







×:表示该有害物质至少在该部件的某一均质材料中的含量超出GB/T 26572 规定的限量要求。



应用











97921A, 97922A: 收缩、变形、烘干、粘合、解冻 / 仅 97923A: 焊接和锡焊



风嘴适用							
97921A	●	●	●				
97922A	●	●	●	●			
97923A	●	●	●	●	●	●	●

操作不当和/或使用已损坏的或错误的风嘴可能会导致热积累, 从而造成机具损坏。

技术数据

		97921A		97922A		97923A	
	V~	230		230		230	
	Hz	50/60		50/60		50/60	
	W	1600		2000		2300	
	°C	350 / 550		80 - 600		80 - 650	
	°F	660 / 1020		180 - 1120		180 - 1200	
	l/min	250 / 400	350 / 500	250 / 450	250 / 550	200 - 500	200 - 550
	cfm	8.8 / 14.1	12.4 / 17.7	8.8 / 15.9	8.8 / 19.4	7.1 - 17.7	7.1 - 19.4
	dB (A)	67 (K = 3)					
	m/s ²	< 2.5 (K = 1.5)					
	g	700				750	
	lbs	1.5				1.7	
	a × b × c mm	230 × 250 × 80 (ø 45)					
	a × b × c inch	9.0 × 9.8 × 3.1 (ø 1.8)					
	ø mm	35.5					
	ø inch	1.4					
		 					

技术参数如有变更，恕不另行通知。

97921A

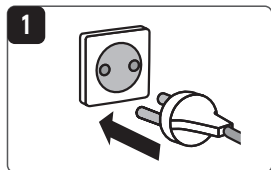

投入运行

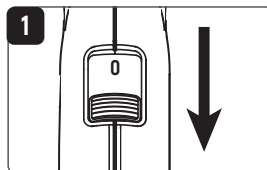
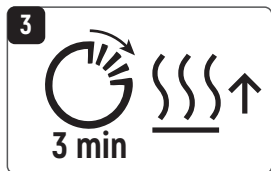
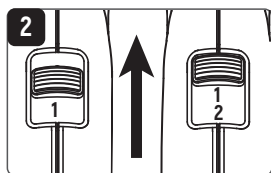

关断

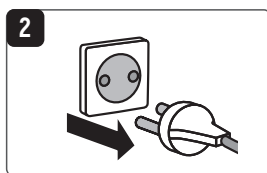

97922A

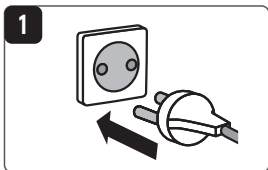

投入运行

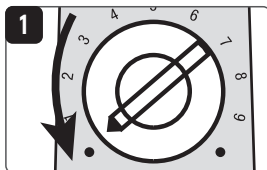
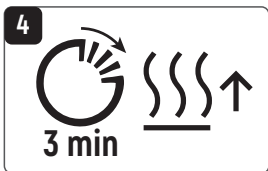
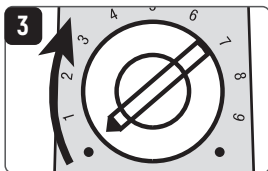
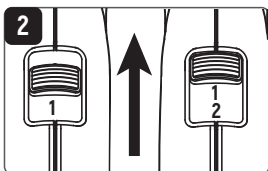

关断

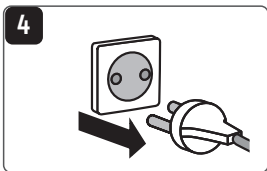
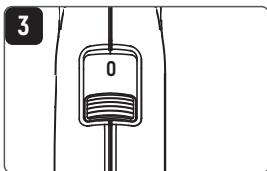
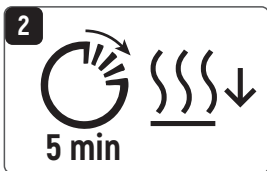

参数说明

97923A

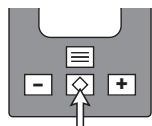

温度/风量选择

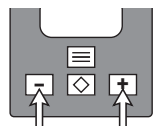

温度/风量 +/-

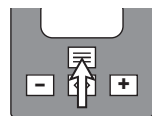

程序键



状态



加热 - 冷却



风扇, 风量



温度显示



Eco 状态



冷却



输入锁定

参数设置

97923A

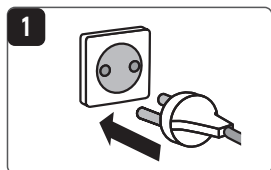

投入运行

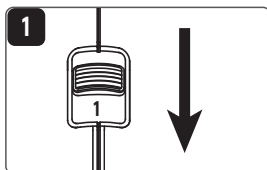
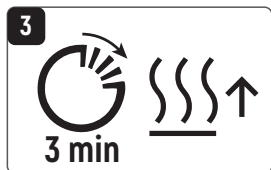
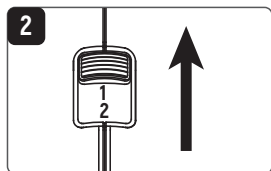

调到1档, 进入冷却状态

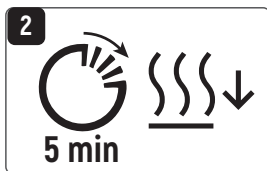

等待热风枪冷却

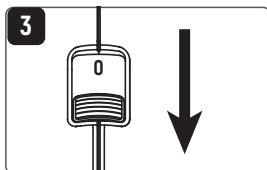

关机

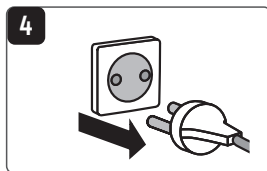

参数设置

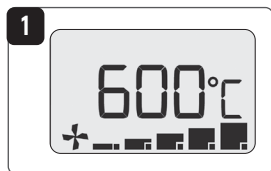

待机模式

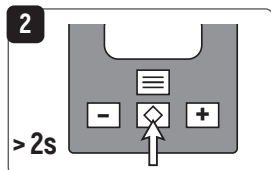

风机功率下降，
进入节能模式

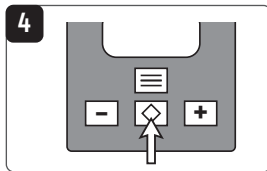
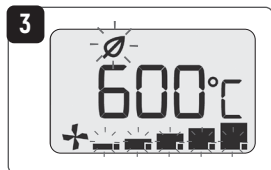

取消待机模式

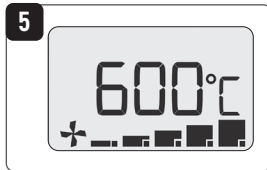

参数设置

97923A

设置温度/风量

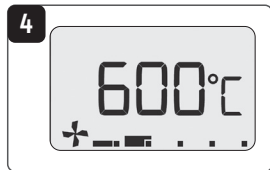
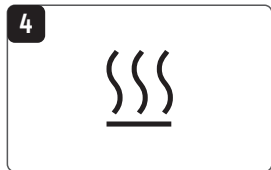
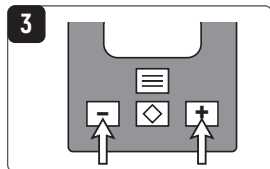
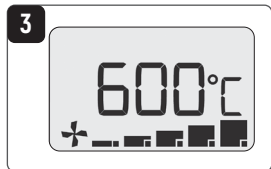
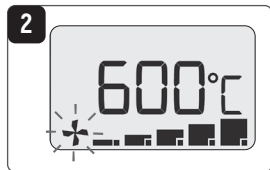
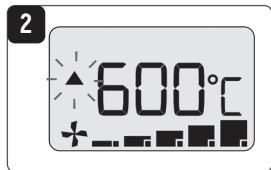
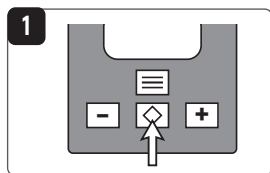
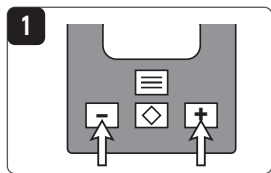

参数设置 97923A

设置参数

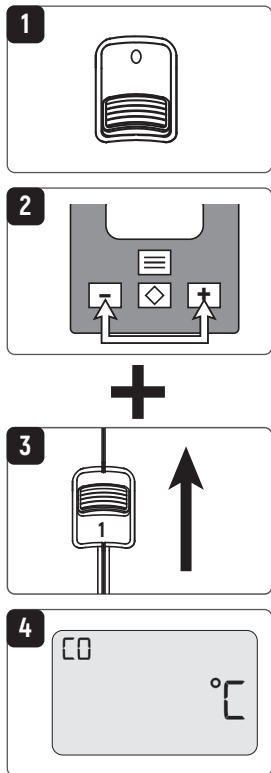

设备重置

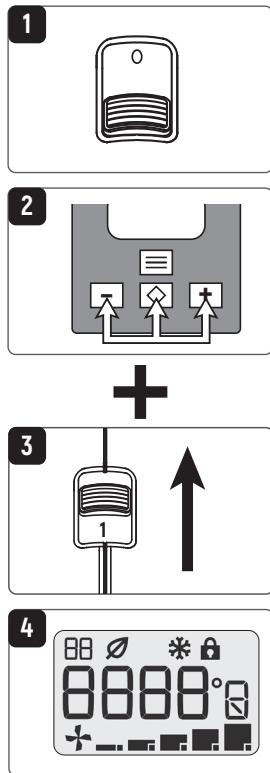

参数设置

设置参数 (C0 - C2)

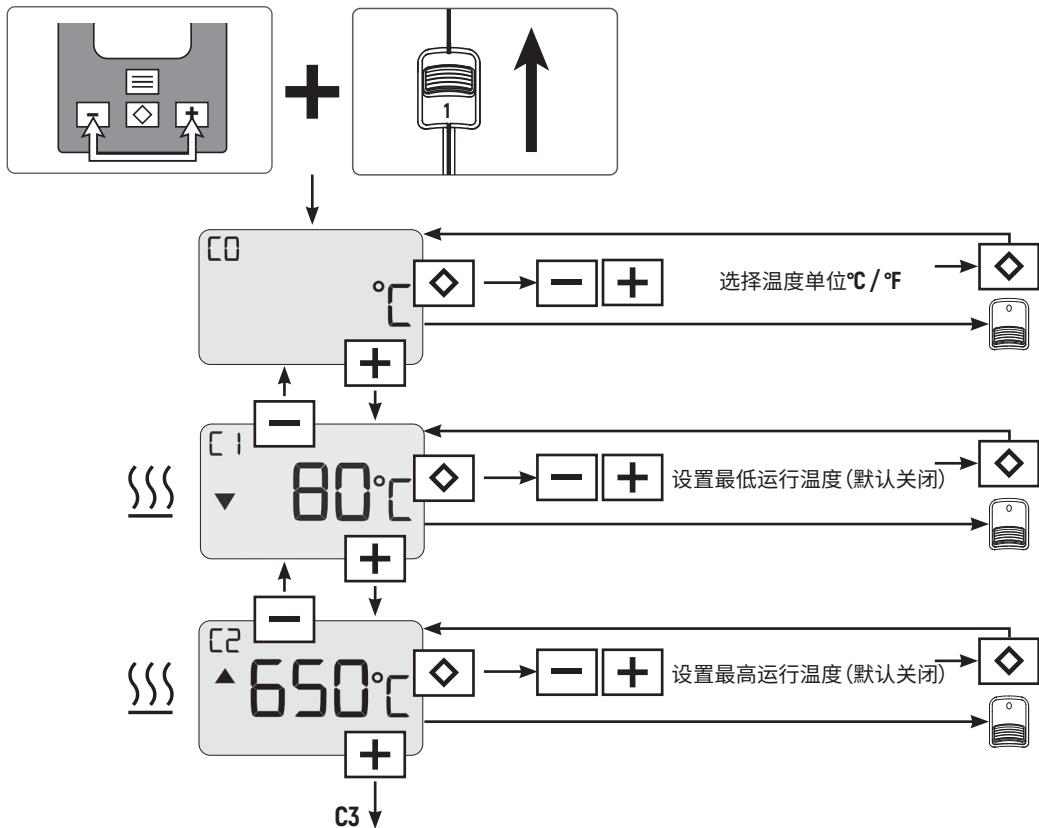

参数设置

设置参数 (C3 - C5)

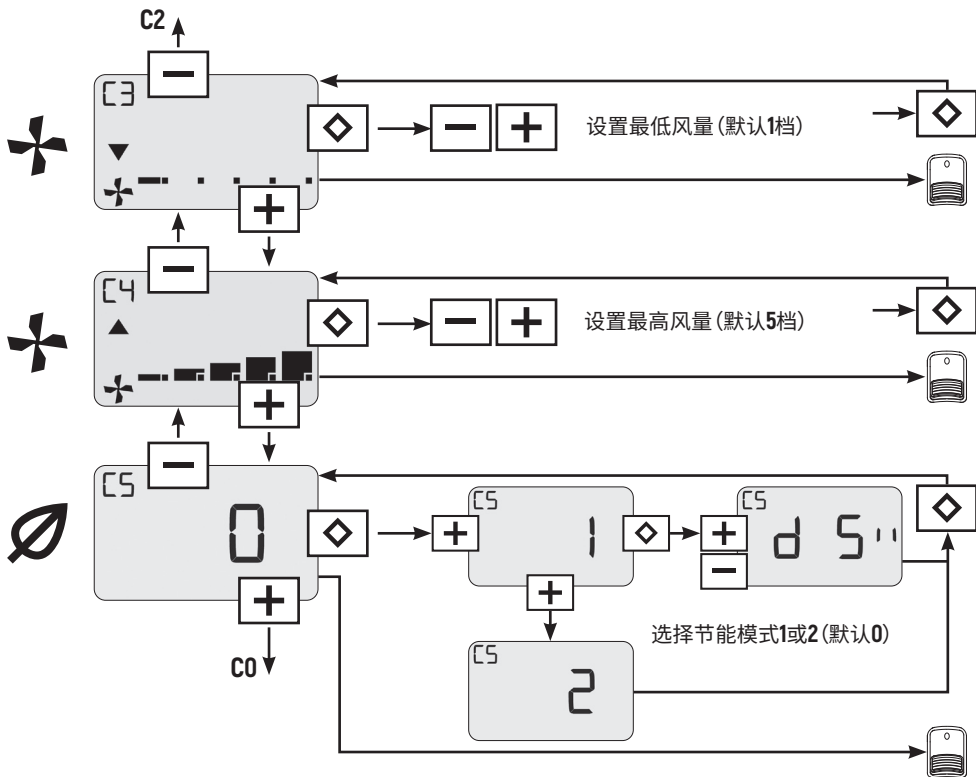

参数设置

设置工作窗口

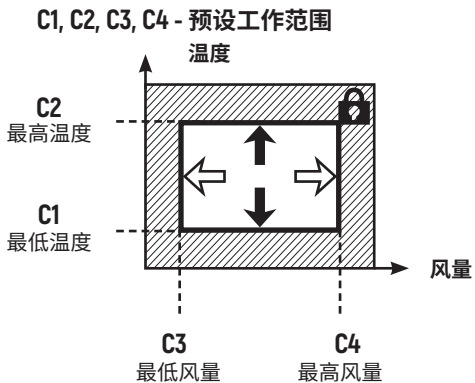

调整设置最低/最高温度 [C1, C2]

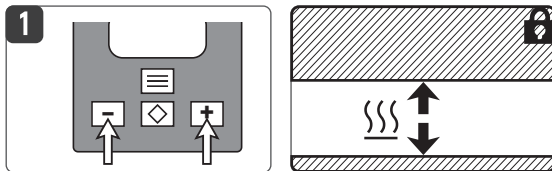

调整设置最低/最高风量 [C3, C4]

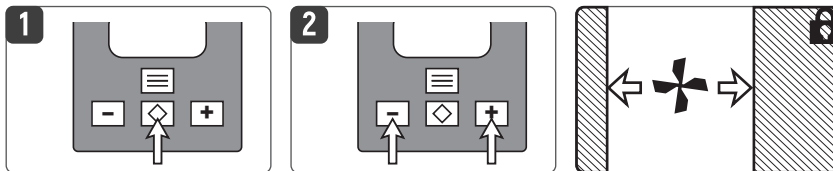

参数设置

节能模式 (eco)

C5 - 节能模式

[C5 = 0] 关闭节能模式

[C5 = 1] 节能模式开启 (可设5 - 60秒激活)

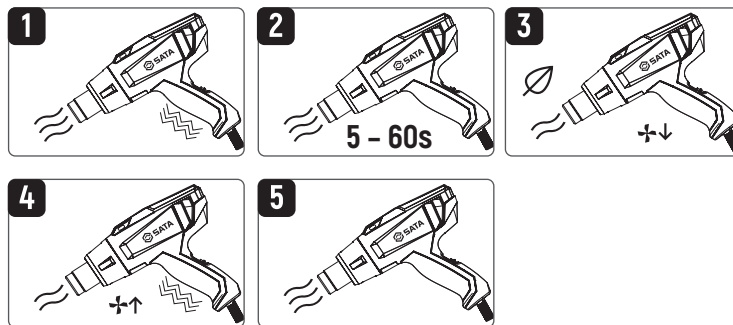

[C5 = 2] 枪身90°姿态节能模式开启

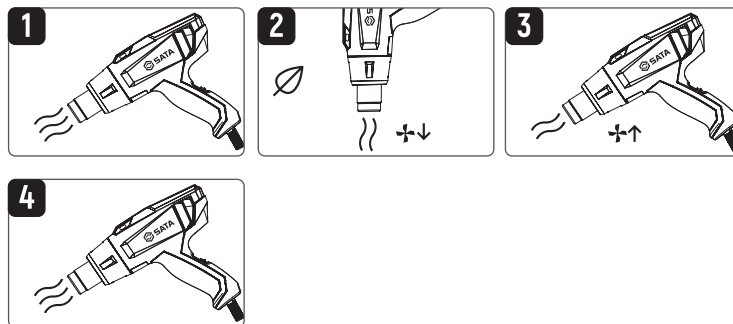

参数设置

存储功能 (P1 - P5)

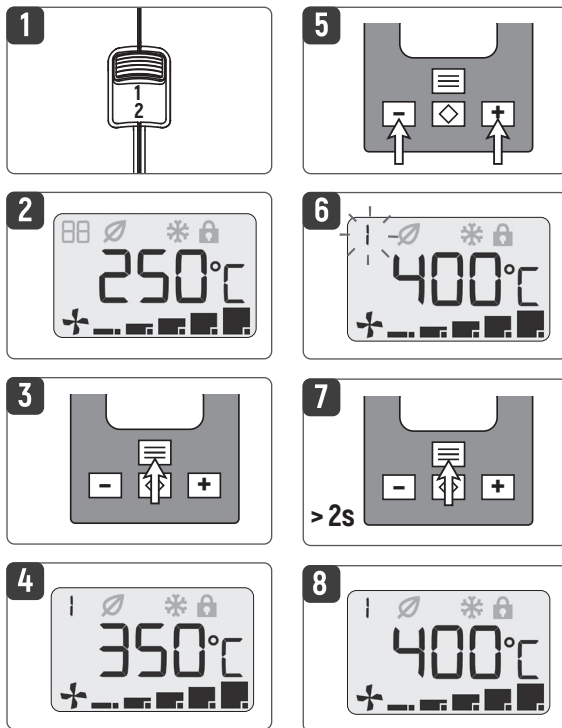

保修



- 相关分销商/卖方所授予的保证或保修权利适用于本工具。在保证或保修请求的情况下，任何制造或工艺缺陷需要修复还是更换，由经销商自行斟酌决定。保修或保证的权利必须由发票或交付的文档进行核实。加热元件不属于保修或保证范围。
- 额外的保证或保修请求应除外，以法律的强制性规定为准。
- 保修或保证不适用于正常磨损、过载或操作不当引起的缺陷。
- 如买方更改或变更工具，保修或保证请求将被驳回。

处置







电气设备、附件及包装均应以环保方式进行回收利用。对我们的产品进行废弃处理时，请遵守相关国家和当地的法规。**以下规定仅针对欧盟国家：**切勿将电器作为生活垃圾处置！

WARNING

-  **DANGER!** Danger when opening up the tool, as live parts are exposed. Before opening, unplug the tool to ensure disconnection from the mains. Before putting into operation, check power supply cord and connector as well as extension cable for electrical and mechanical damage.
-  Incorrect use of the Hot Air Tool (eg. overheating of the material) can cause a **fire and explosion hazard**, especially near combustible materials and explosive gases. Do not apply to the same place for a long time. Heat can ignite flammable materials which are not in view.
-  **Fire and burn hazard!** Do not touch the heating element housing and air nozzle when they are hot as they can cause **burns**. Let the tool cool down. Do not point the hot air flow in the direction of people or animals.
Before replacing a nozzle or storage after use, place the tool vertical down on its standing surface and allow it to cool down completely. If the Hot Air Tool switches off autonomously in operation (thermal relay), switch tool off or disconnect the power supply from mains. Before reusing, let the tool cool down.

CAUTION

-  The **voltage rating** stated on the tool must correspond to the mains voltage. EN 61000-3-11; $Z_{\max} = 0.215 \Omega + j 0.134 \Omega$. If necessary, consult supply authority.
-  For personal protection on building sites we **strongly recommend** the tool be connected to a **RCCB (Residual Current Circuit Breaker)**.
-  The tool must be operated **under supervision**.
This tool may be used by children aged 8 or above and by persons with reduced physical, sensory or mental capabilities or lack of experience and knowledge if they are supervised or have been given instructions on how to use the tool safely and understand the hazards involved. Do not allow children to play with the tool. Children are not allowed to clean or carry out maintenance work on the tool without supervision.
-  Protect tool from **damp and wet**.
-  **Repairs** should only be carried out by **authorized service points**. Restricted to use with **original accessories and spare parts**.

Part name and content of harmful substances in the product

Part Name	Harmful substances					
	Pb	Hg	Cd	Cr (VI)	PBB	PBDE
Plastic Housing	○	○	○	○	○	○
Metal housing/Screw	○	○	○	×	○	○
Motor	○	○	○	○	○	○
Control Components	×	○	○	×	○	○
Power Supply	×	○	○	○	○	○
Heating Core	×	○	×	×	○	○

This form is prepared in accordance with SJ / T 11364.

○: Indicates that the content of the hazardous substance in all homogeneous materials of the component is below the limit specified in GB/ 26572







×: Indicates that the content of the hazardous substance in at least one homogeneous material the component exceeds the limit specified in GB/ 26572



Application











97921A, 97922A: Shrinking, Deforming, Drying, Joining adhesives, Defrosting / **ONLY 97923A:** Welding, Soldering



Compatibility of accessories							
97921A	●	●	●				
97922A	●	●	●	●			
97923A	●	●	●	●	●	●	●

Incorrect handling or use of wrong or defect nozzle can lead to an accumulation of heat and thus damage the unit.

Technical Data

		97921A		97922A		97923A	
	V~	230		230		230	
	Hz	50/60		50/60		50/60	
	W	1600		2000		2300	
	°C	350 / 550		80 - 600		80 - 650	
	°F	660 / 1020		180 - 1120		180 - 1200	
	l/min	250 / 400	350 / 500	250 / 450	250 / 550	200 - 500	200 - 550
	cfm	8.8 / 14.1	12.4 / 17.7	8.8 / 15.9	8.8 / 19.4	7.1 - 17.7	7.1 - 19.4
	dB (A)	67 (K = 3)					
	m/s ²	< 2.5 (K = 1.5)					
	g	700				750	
	lbs	1.5				1.7	
	a × b × c mm	230 × 250 × 80 (ø 45)					
	a × b × c inch	9.0 × 9.8 × 3.1 (ø 1.8)					
	ø mm	35.5					
	ø inch	1.4					
		 					

Technical data and specifications are subject to change without prior notice.

97921A

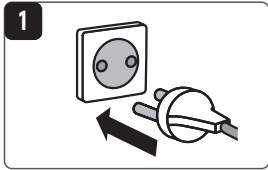

Start-up

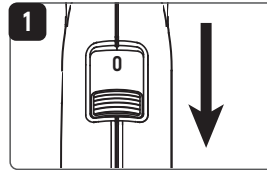
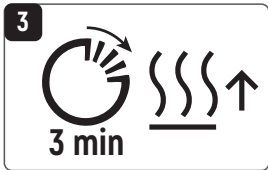
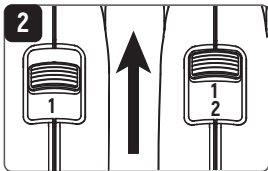

Switching Off

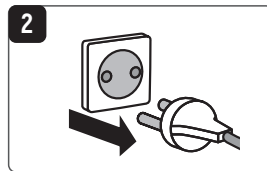

97922A

Start-up

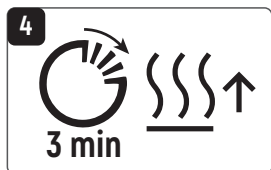
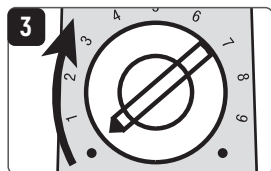
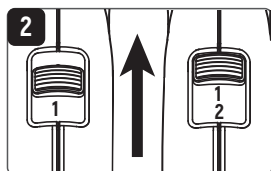
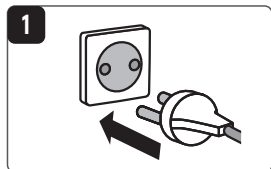

Switching Off

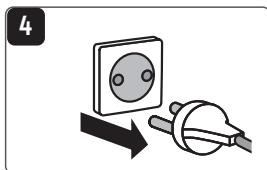
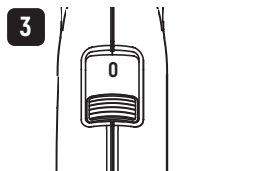
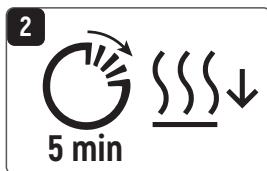
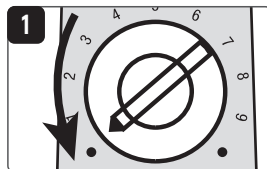

Parameter Description

97923A

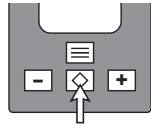

Temperature/air flow selection

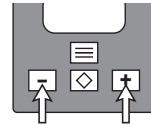

Temperature/air flow +/-

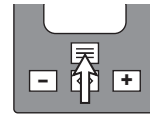

Program button

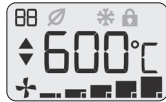

Status



Heating - Cooling



Blowers, air volume



Temperature set point



Eco status



Cool down



Input interlock

Parameter Setup

97923A

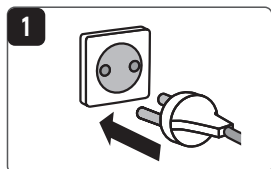

Start-up

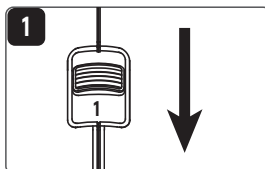
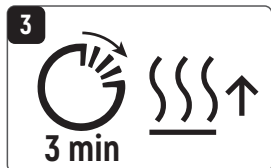
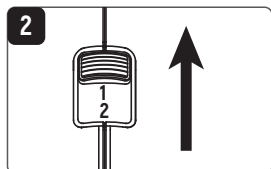

Switching Off
Turn to stage 1
enter the cooling state

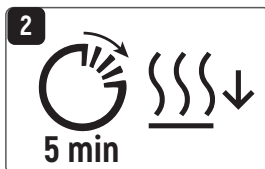

wait for cooling

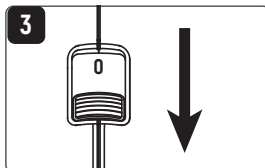

Switching Off

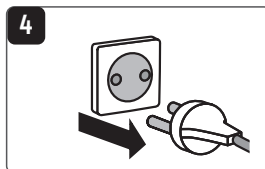

Parameter Setup

97923A

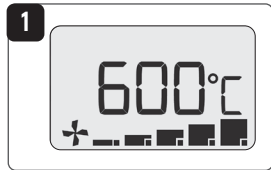

Standby mode

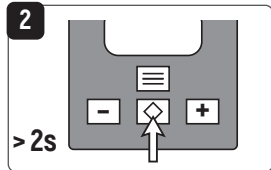

Entering ECO mode

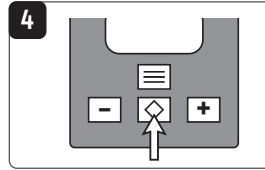

Cancel standby mode

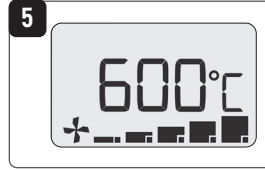

Parameter Setup 97923A

Setting temperature / air volume

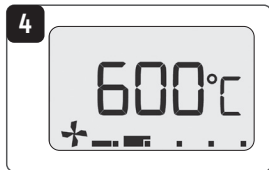
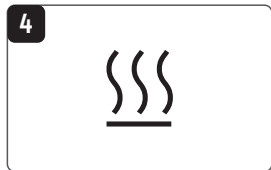
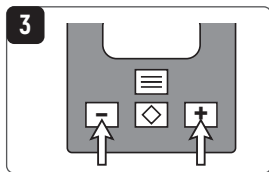
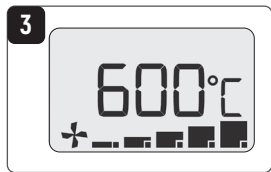
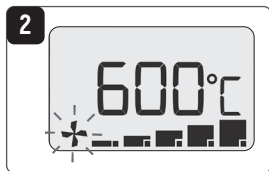
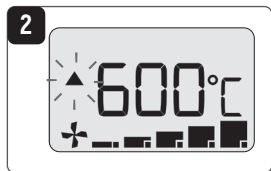
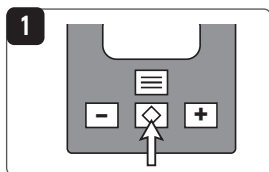
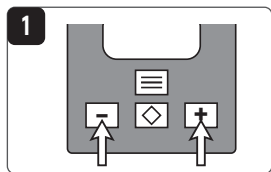

Parameter Setup 97923A

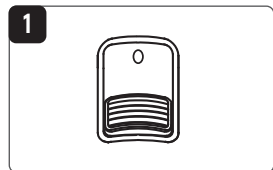

Configuring device

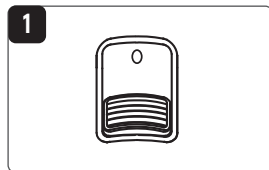
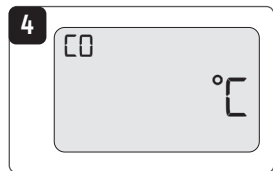
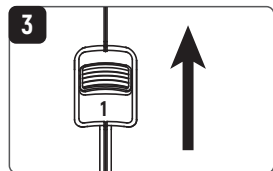
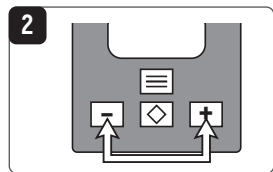

Resetting configuration

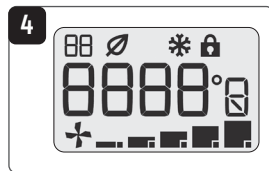
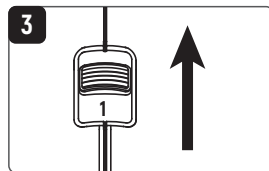
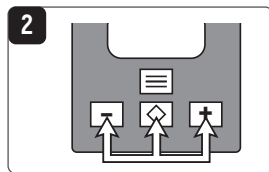

Parameter Setup

Configuration C0 - C2

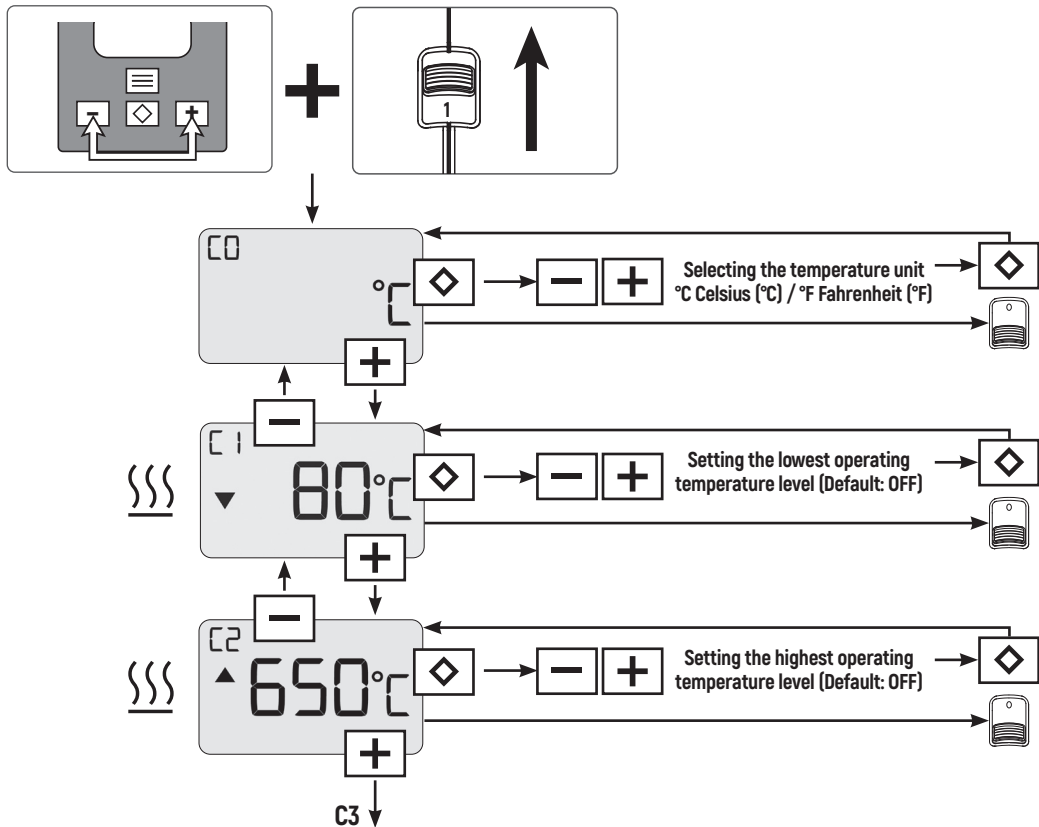

Parameter Setup

Setting working window

C1, C2, C3, C4 - PREDEFINE OPERATING RANGE

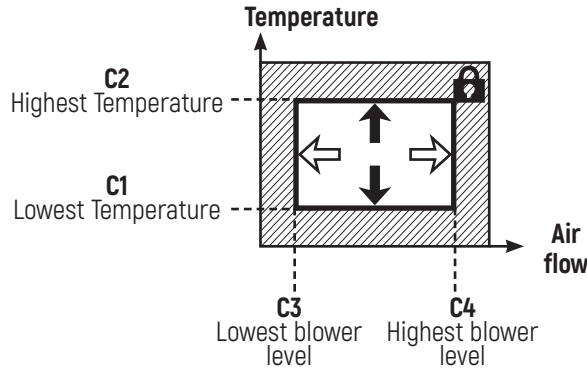

Setting the lowest / highest adjustable temperature level (C1, C2)

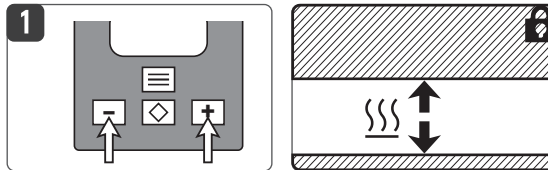

Setting the lowest / highest adjustable blower level (C3, C4)

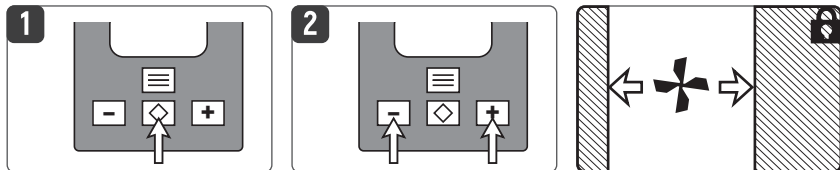

Parameter Setup

Energy saving mode (eco)

C5 - ECO MODE

(C5 = 0) ECO function turned off

(C5 = 1) ECO function turned on (5 - 60 sec delay until ECO activation)

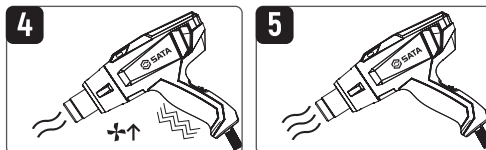
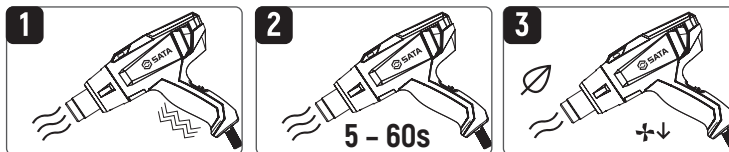

(C5 = 2) ECO 90° tilt angle function turned on (immediat ECO activation if tilt angle = 90°)

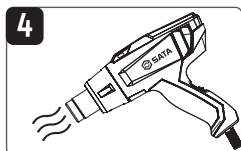
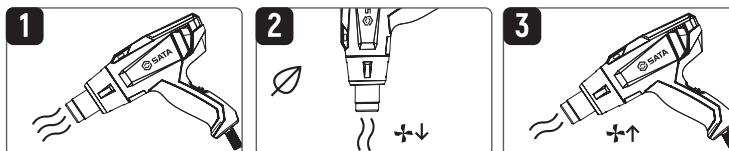

Parameter Setup

Memory function (P1 – P5)

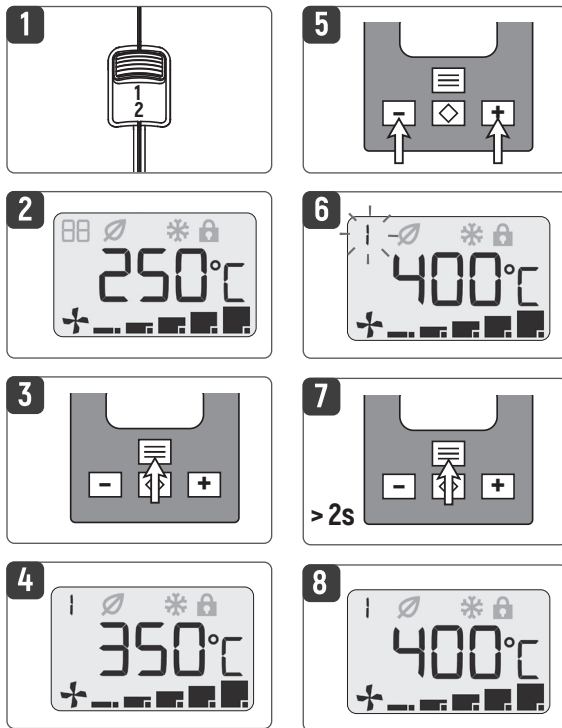

Warranty

- For this tool, the guarantee or warranty rights granted by the relevant distributor/seller shall apply. In case of guarantee or warranty claims any manufacturing or workmanship defects will either be repaired or replaced by the distributor at its discretion. Warranty or guarantee rights have to be verified by an invoice or a delivery document. Heating elements shall be excluded from warranty or guarantee.
- Additional guarantee or warranty claims shall be excluded, subject to mandatory provisions of law.
- Warranty or guarantee shall not apply to defects caused by normal wear and tear, overload or improper handling.
- Warranty or guarantee claims will be rejected for tools that have been altered or changed by the purchaser.

Disposal



Electrical equipment, accessories and packaging should be recycled in an environmentally friendly way. **For EU countries only:** Do not dispose of electrical equipment with household refuse!

适用型号 / Model :

97921A/97922A/97923A

版本号 / Version No. :

V-SE-9792NA-220118

世达工具（上海）有限公司
SATA TOOL (SHANGHAI) LIMITED

客户服务：上海市浦东新区碧波路 177 号 A 座 302 室
Customer service: Room 302, Area A, No. 177, Bibo Road, Pudong New Area, Shanghai

邮编 / Post: 201203

电话 / Tel.: [86 21] 6061 1919

传真 / Fax: [86 21] 6061 1918