

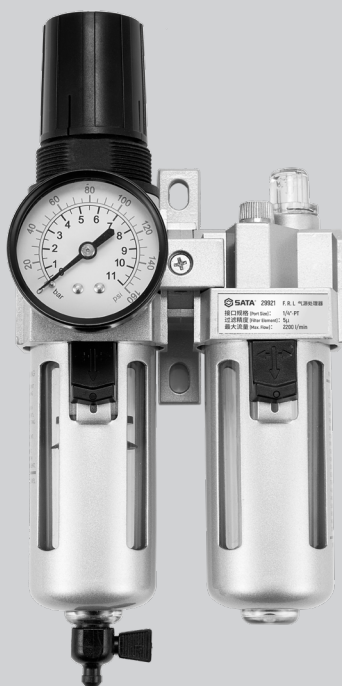

气源处理器  
Filter/Regulator/Lubricator

29921/29931/29941



使用说明书 \ User's Manual

中文

EN



## 过滤 - 调压组合

### 一. 安装指示

1. 各种口径组合须符合最大流量需求。
2. 使用压力范围 10Kgf/cm<sup>2</sup> 以下。
3. 安装方向 - 空气流向须以本体上三角形“▷”记号为基准。
4. 安装姿势 - 排水口向下。
5. 安装位置 - 尽可能靠近需保护之器具。
6. 安装场所 - 避免阳光直射, 热源, 有害之化学物质附近。
7. 安装排水管于排口下, 以利水排入适当区域。

### 二. 调整

1. 调整压力  
将件 28 向上拉起, 顺时针方向旋转, 压力上升; 逆时针方向旋转, 压力下降, 调整至所需压力, 将件 28 按下呈上锁状态。
2. 排水  
- 无空气压力时, 水自动排出。  
- 有空气压力时自动止水, 当水位过高才强迫排水, 旋转件呈“▽”向下状态, 水立即出, 排水完毕后, 旋转件呈“△”向上状态。
3. 当水位超过上限时, 请立即排水, 否则将造成除湿不良。

### 三. 保养

1. 关闭空气供应并排出空气于大气中。
2. 先依 ↓ 向下再 ← → 向左或右转件 8, 对准件 1 孔拉出件 3, 接着逆时针旋起件 5, 即可取下件 6 滤网。
3. 取件 6 滤网, 将空气由内向外吹, 即可重复使用。
4. 取件 2 透明 PC 杯, 使用清洁干布擦拭即可, 不可使用任何会破坏 PC 材质之化学物质。

## 润滑器

### 一. 安装指示

1. 安装位置 - 尽可能靠近需润滑之器具。
2. 直接安装过滤 - 调压组合于润滑器之前。
3. 准备润滑油放入储油杯。

### 二. 滴下油量调整

1. 针阀调整: 顺时针旋转, 滴下量减少。  
逆时针旋转, 滴下量增加。
2. 空气流量调整: 设定针阀后。  
空气流量大, 滴下量多。  
空气流量小, 滴下量少。

### 三. 加油方法

1. 可以不关闭空气管路而进行加油作业。
2. 逆时针旋起件 40
3. 使用 ISO-VG32 或相当品质之润滑油。
4. 加油至上限后, 将件 40 销紧, 不久油即滴下。
5. 不可直接将件 34 储油杯拆下直接加油。

### 四. 保养

1. 关闭空气供应和排出空气于大气中。
2. 先依 ↓ 向下再 ← → 向左或右转件 8, 对准件 1 孔拉出件 3。
3. 取件 34 透明 PC 杯, 使用清洁的干布擦拭即可, 不可使用任何会破坏 PC 材质之化学物质。
4. 重新组立时, 请确认 SEAL 和 ORING 是否正确。

#### ▲ 注意:

1. 本产品仅可使用于工业空气压力系统, 不可使用于超过此等级所标示之压力与温度场所。其它流体亦不可使用, 例: 瓦斯、酒精、汽油…对这产品是有伤害, 将导致泄漏或燃烧的危险。
2. 塑料杯和塑料零件, 假如暴露于油漆, 不佳油品, 清洁剂, 与化学物口 (醋酸, 树脂, 氯乙稀…等) 将造成材质退化等不良情事发生。

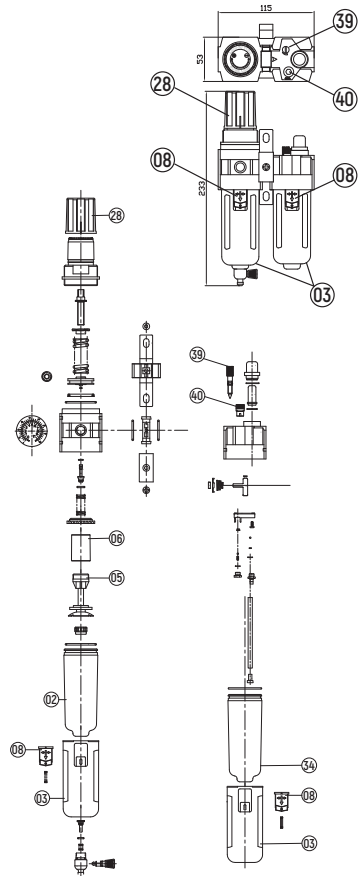

## FILTER-REGULATOR SET

### 1. Installation instruction:

- The assembly of all calibration shall meet the maximum flow requirement.
- Maximum pressure of 9.9kgf/cm<sup>2</sup>.
- Direction –air flow in the triangle "▷" on the primary unit.
- Position –water discharge, the triangle "▽" downward.
- Site –as close to the unit to be protected as possible.
- Place –free of direct sun shine , hot area, and hazardous chemicals.
- The water drainage shall be deployed beneath the water discharge for outlet of water into proper area.

### 2. Regulation:

- Regulation of pressure
  - Raise off the part 28 and turn it clockwise to have the pressure up and counterclockwise to have the pressure down.
  - Regulate the pressure to the desired level and press down the part 28 to lock it up.
- Drainage
  - If no pneumatic pressure, water will discharge.
  - When there is pneumatic pressure coming, discharge will be stopped automatically. When water exceeds the level, please drain off the water manually by turning off the part 13 to "▽" upward then water will be discharged. After drainage is done, please turn of the part 13 to "△" downward.
  - when the water level exceeds the maximum limit, please drain off the water to keep optimal dehumidification.

### 3. Maintenance:

- Shut off the air supply and discharge the air into the atmosphere
- According to the sign on the part 8 ↓ press downwards, turn the part 8 ← → leftward or rightward just straight to the holes of part 1 and take out the part 3, then turn off the part 5 counter-clockwise to remove the part 6 filter element.
- The filter that makes the air flow outward, is available for repeated use
- Clean the transparent P.C. cup with a clean and dry cloth, do not use any chemical that would be hazardous to the P.C. material.

## LUBRICATOR

### 1. Installation instruction:

- Site-as close to the unit to be lubricated as possible.
- Direct installation of filter-pressure regulator before the lubricator.
- Add the lubricant into the oil cup.

### 2. Oil drop regulation:

- Regulation of the needle valve: Turn it clockwise for less oil drop. Turn it counterclockwise for more oil drop.
- Air flow regulation: After setting the needle valve. More air flow, more oil drop. Less air flow, less oil drop.

### 3. Oiling:

- Oiling is available without closing the air piping.
- Turn off the part 40 counterclockwise.
- Use ISO-VG32 or similar lubricants.
- After adding oil to the maximum level, tighten the part 40 to have oil drop.
- Do not remove the oil cup directly for oiling.

### 4. Maintenance

- Shut off the air supply and discharge the air into the atmosphere.

- According to the sign on the part 8 ↓ press downwards, turn the part 8 ← → leftward or rightward just straight to the holes of part 1 and take out the part 3.
- Remove the part 34 transparent P.C. cup and clean it with a dry and clean cloth, do not use any chemical that would be hazardous to the P.C. material.
- When assembling the kit again, please be sure that the SEAL and O-RING are in correct positions.

#### ▲ NOTICE:

- The product in reference is applicable in industrial pressure systems rather than in premises of pressure and temperature exceeding the marked ones This is not applicable in other fluids neither such as alcohol, gas, gasoline ...as it is hazardous to the products by presenting leakage or flame.
- The Plastic cups and Parts, when exposed to paints, poor oil products, detergents and chemicals (resin, polyethylene, acetic acid and others) would lead to aging in material and other defects.

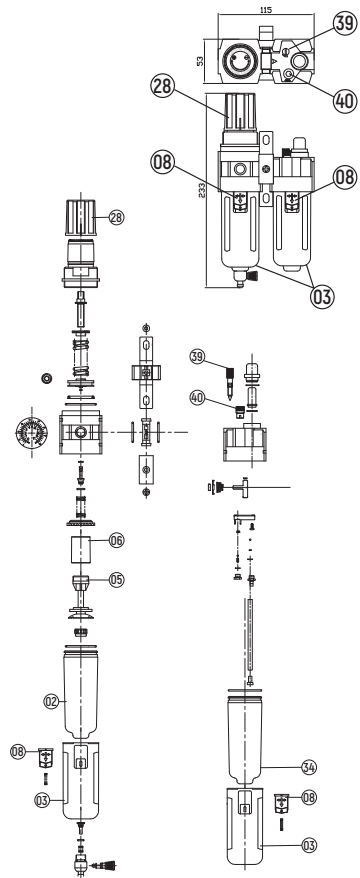

适用型号 / Model

29921/29931/29941

版本号 / Version No.

V\_29921-41\_0323

**世达工具（上海）有限公司**  
**SATA TOOL (SHANGHAI) LIMITED**

客户服务：上海市碧波路 177 号 3 楼  
Customer service: 3F, No. 177, Bibo Road, Shanghai  
邮编 / Postleitzahl: 201203  
电话 / Tel. : {86 21} 6061 1919  
传真 / Fax : {86 21} 6061 1918