

G系列预置式扭力扳手使用说明

G Series Adjustable Torque Wrench Operation Instruction

产品编号	Nm	Kgfm	Lbf.ft	精度	□	产品长度(MM)	产品重量(KG)
96431	200-1000	20-100	150-750	±4%	1"	1030	9.7
96433	500-2000	50-200	350-1500	±4%	1"	1400	18



驱动头向上推出可用于反向操作

拉出手柄尾端折叠式扭力调节钮。

Pull out the foldaway torque adjuster situated on the handle turning it.



拉出手柄尾端折叠式扭力调节钮。

Turn the foldaway torque adjuster to select the preset torque required and put it back in the handle.

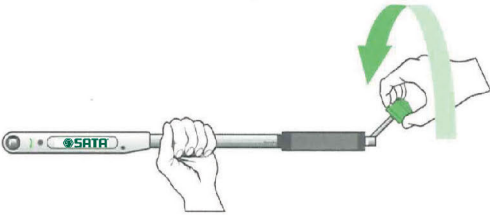

调节扭力时，需从小扭力值调节到所需的设定值。

The required pre-set torque must be selected starting from a lower value than the required one.

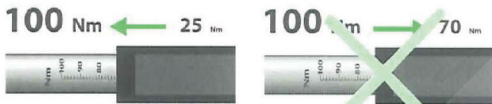

在使用过程中，当扭力值达到预设值后，扳手会自动的发出便于察觉的咔哒声响。

During the use, a strong click which is acoustically and mechanically perceptible will indicate that the torque has been reached.

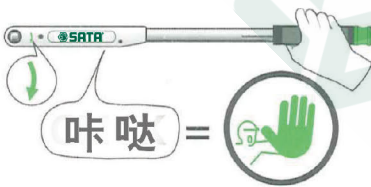

经常给扭力扳手内部结构上润滑油。

Keep lubricated the mechanisms.

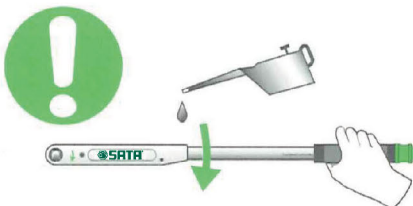

为了保证扭力扳手的精度，每次使用后要恢复到最小扭力值。

To safeguard torque accuracy keep the tool set at the minimum load after use.

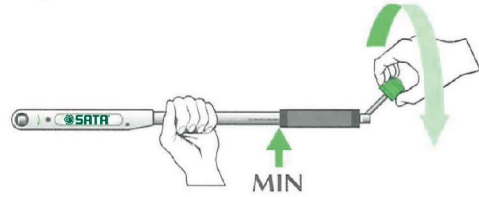

使用后，请将扭力扳手放回原来的盒子中去。

After using put back the torque wrench in its proper case.

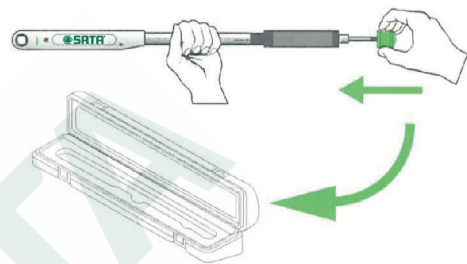

**不正确的使用
IMPROPER USES**

